

**PCB Connector Series**

**KLS1-XL1-1.25 Pitch=1.25mm TYPE**

**Electrical Specification:**

Rated Voltage: 50/250V AC.DC  
 Rated Current: 0.7A 2A  
 Contact Resistance: 0.02 Ohm max  
 Insulation Resistance: 1000M Ohm min  
 Withstand voltage: 800V AC/MIN  
 Temperature range for usage : -25°C~+85°C  
 P.C board thickness : 0.8~1.6mm

**Material:**

Housing: PA66 (PA66) UL94V-2  
 Contacts: Brass or Phosphor Bronze  
 Plating: Tin 50u" over 100u" nickel  
 Wire range : AWG#32~#22  
 Straight and Right Male pin Material: brass / tin-plated

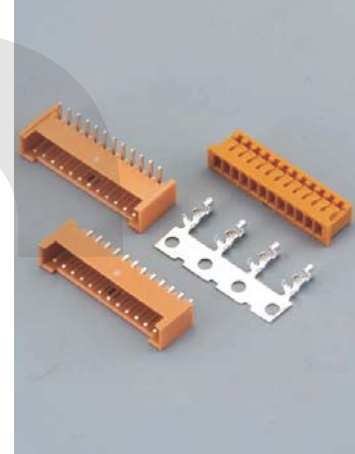

**Housing**

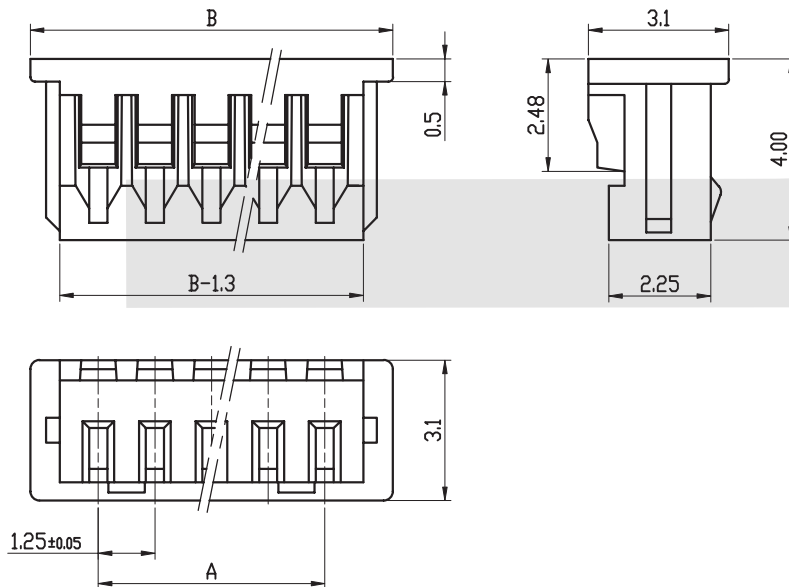

Poles	Dimensions mm	
	A	B
02	1.25	4.25
03	2.50	5.50
04	3.75	6.75
05	5.00	8.00
06	6.25	9.25
07	7.50	10.50
08	8.75	11.75
09	10.00	13.00
10	11.25	14.25
11	12.50	15.50
12	13.75	16.75
13	15.00	18.00
14	16.25	19.25
15	17.50	20.50
16	18.75	21.75

**ORDER INFORMATION**

**Product NO.:** KLS1-XL1-1.25-02-H

Series No. \_\_\_\_\_ Type: H=Housing  
 Pitch: 1.25=1.25mm T=Terminal  
 PIN Number: 02 ~ 16Pin S=Straight Male pin  
 R=Right Male pin

**PCB Connector Series**

**KLS1-XL1-1.25 Pitch=1.25mm TYPE**

**Electrical Specification:**

- Rated Voltage: 50/250V AC.DC
- Rated Current: 0.7A 2A
- Contact Resistance: 0.02 Ohm max
- Insulation Resistance: 1000M Ohm min
- Withstand voltage: 800V AC/MIN
- Temperature range for usage : -25°C~+85°C
- P.C board thickness : 0.8~1.6mm

**Material:**

- Terminal Material: Phosphor bronze Tin-plated
- Wire Range: AWG # 32 ~ # 28
- Plating: Tin 50u" over 100u" nickel

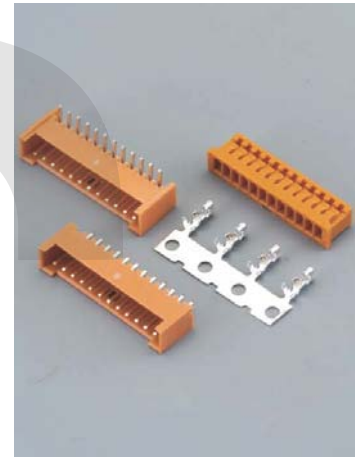

**Terminal**

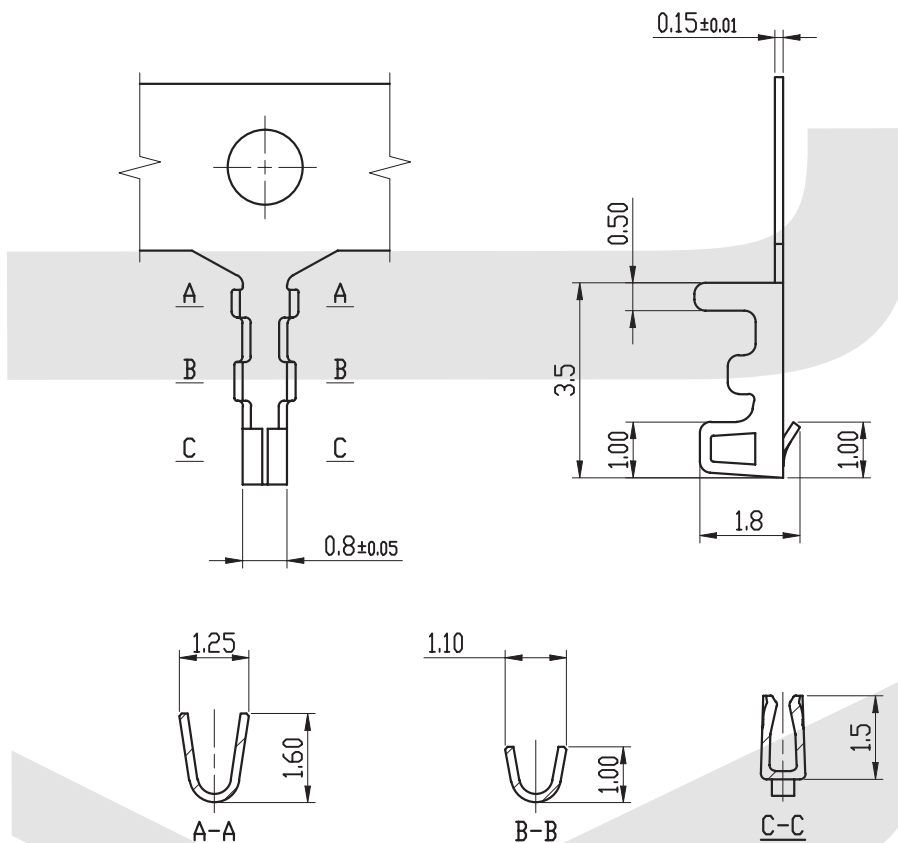

**ORDER INFORMATION**

Product NO.: **KLS1-XL1-1.25-T**

Series No. \_\_\_\_\_ Type: H=Housing  
 Pitch: 1.25=1.25mm \_\_\_\_\_ T=Terminal  
 S=Straight Male pin  
 R=Right Male pin

**PCB Connector Series**

**KLS1-XL1-1.25 Pitch=1.25mm TYPE**

**Electrical Specification:**

Rated Voltage: 50/250V AC.DC  
 Rated Current: 0.7A 2A  
 Contact Resistance: 0.02 Ohm max  
 Insulation Resistance: 1000M Ohm min  
 Withstand voltage: 800V AC/MIN  
 Temperature range for usage : -25°C~+85°C  
 P.C board thickness : 0.8~1.6mm

**Material:**

Housing: PA66 (PA66) UL94V-2  
 Contacts: Brass or Phosphor Bronze  
 Plating: Tin 50u" over 100u" nickel  
 Wire range : AWG#32~#22  
 Straight and Right Male pin Material: brass / tin-plated

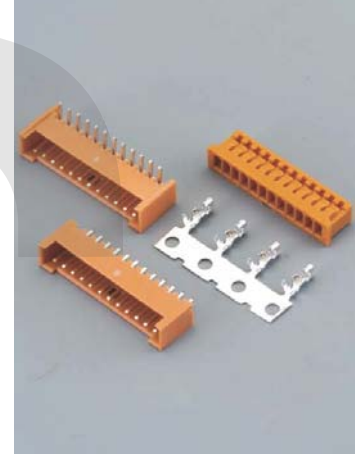

**Straight Male Pin**

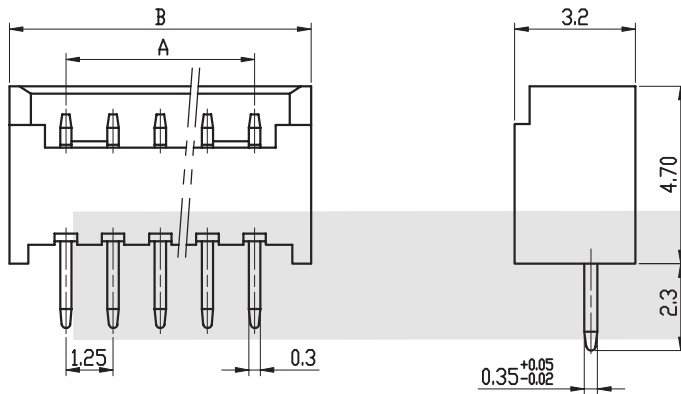

Poles	Dimensions mm	
	A	B
02	1.25	4.25
03	2.50	5.50
04	3.75	6.75
05	5.00	8.00
06	6.25	9.25
07	7.50	10.50
08	8.75	11.75
09	10.00	13.00
10	11.25	14.25
11	12.50	15.50
12	13.75	16.75
13	15.00	18.00
14	16.25	19.25
15	17.50	20.50
16	18.75	21.75

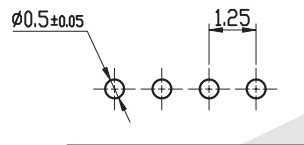
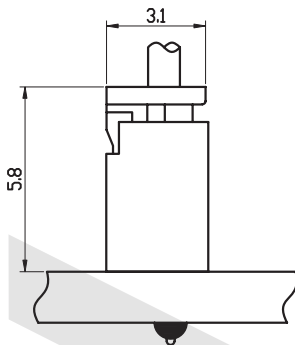

P. C. B LAYOUT

**ORDER INFORMATION**

**Product NO.: KLS1-XL1-1.25-02-S**

Series No. \_\_\_\_\_ Type: H=Housing  
 Pitch: 1.25=1.25mm \_\_\_\_\_ T=Terminal  
 PIN Number: 02 ~ 16Pin \_\_\_\_\_ S=Straight Male pin  
 R=Right Male pin

**PCB Connector Series**

**KLS1-XL1-1.25 Pitch=1.25mm TYPE**

**Electrical Specification:**

Rated Voltage: 50/250V AC.DC  
 Rated Current: 0.7A 2A  
 Contact Resistance: 0.02 Ohm max  
 Insulation Resistance: 1000M Ohm min  
 Withstand voltage: 800V AC/MIN  
 Temperature range for usage : -25°C~+85°C  
 P.C board thickness : 0.8~1.6mm

**Material:**

Housing: PA66 (PA66) UL94V-2  
 Contacts: Brass or Phosphor Bronze  
 Plating: Tin 50u" over 100u" nickel  
 Wire range : AWG#32~#22  
 Straight and Right Male pin Material: brass / tin-plated

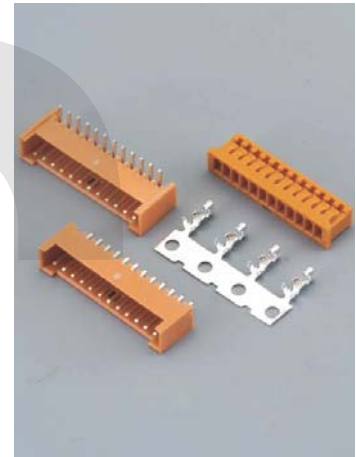

**Right Male Pin**

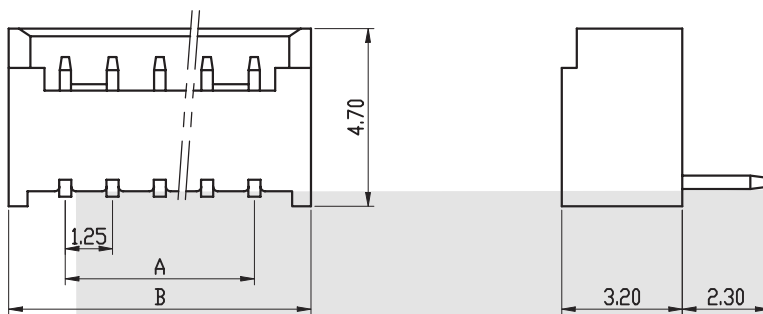

Poles	Dimensions mm	
	A	B
02	1.25	4.25
03	2.50	5.50
04	3.75	6.75
05	5.00	8.00
06	6.25	9.25
07	7.50	10.50
08	8.75	11.75
09	10.00	13.00
10	11.25	14.25
11	12.50	15.50
12	13.75	16.75
13	15.00	18.00
14	16.25	19.25
15	17.50	20.50
16	18.75	21.75

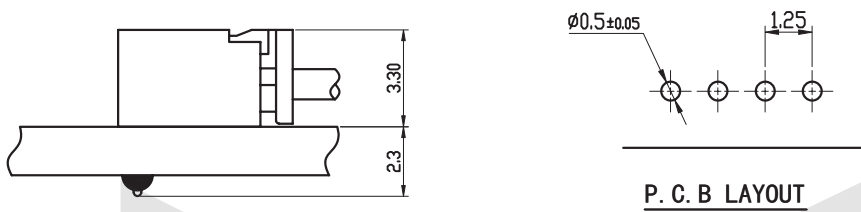

P. C. B LAYOUT

**ORDER INFORMATION**

**Product NO.: KLS1-XL1-1.25-02-R**

Series No. \_\_\_\_\_ Type: H=Housing  
 Pitch: 1.25=1.25mm \_\_\_\_\_ T=Terminal  
 PIN Number: 02 ~ 16Pin \_\_\_\_\_ S=Straight Male pin  
 R=Right Male pin

## PCB Connector Series

KLS1-XL1-1.25 Pitch=1.25mm TYPE

### Electrical Specification:

Rated Voltage: 50V AC/DC  
 Rated Current: 1.0A  
 Contact Resistance: 0.02 Ohm max  
 Insulation Resistance: 500M Ohm min  
 Withstand voltage: 500V AC/MIN  
 Temperature range for usage : -25°C~+85°C

### Material:

Housing: LCP UL94V-0  
 Contacts: Phosphor bronze, tin-plated  
 Plating: Tin 50u" over 100u" nickel

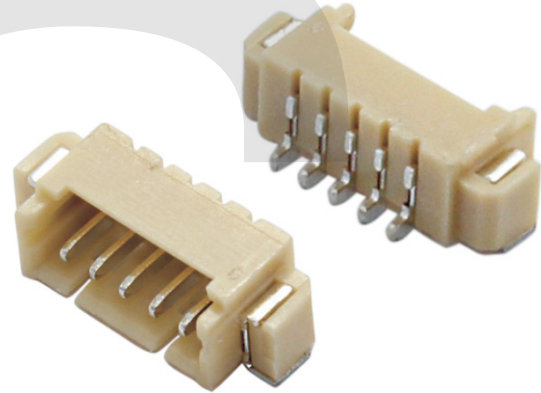

### Horizontal SMT

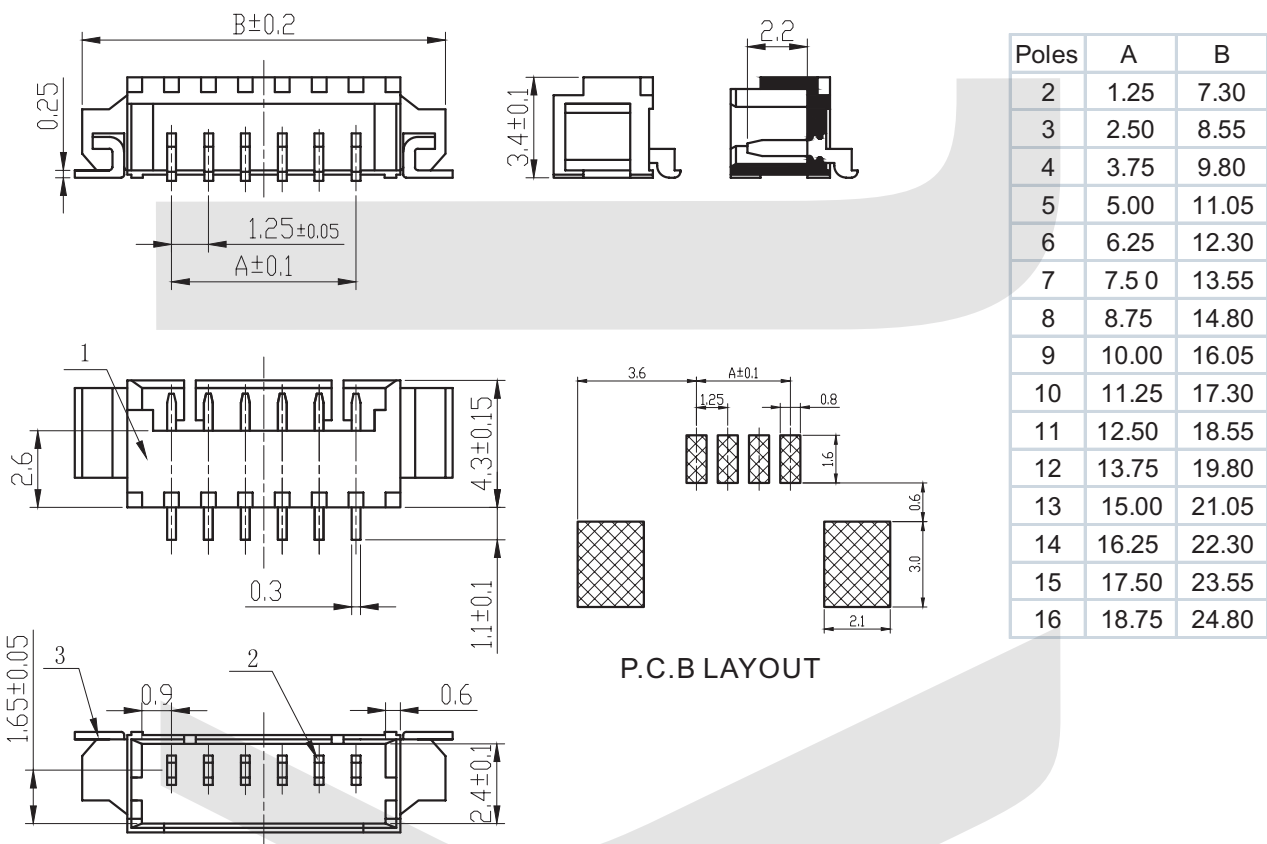

## ORDER INFORMATION

Product NO.: KLS1-XL1-1.25-02-RM

Series No. \_\_\_\_\_ Type: H=Housing  
 Pitch: 1.25=1.25mm \_\_\_\_\_ S=Straight Male pin  
 PIN Number: 2~16pin \_\_\_\_\_ VM = Vertical SMT T=Terminal  
 R=Right Male pin  
 RM = Horizontal SMT

## PCB Connector Series

KLS1-XL1-1.25 Pitch=1.25mm TYPE

### Electrical Specification:

Rated Voltage: 50V AC/DC  
 Rated Current: 1.0A  
 Contact Resistance: 0.02 Ohm max  
 Insulation Resistance: 500M Ohm min  
 Withstand voltage: 500V AC/MIN  
 Temperature range for usage : -25°C~+85°C

### Material:

Housing: LCP UL94V-0  
 Contacts: Phosphor bronze, tin-plated  
 Plating: Tin 50u" over 100u" nickel

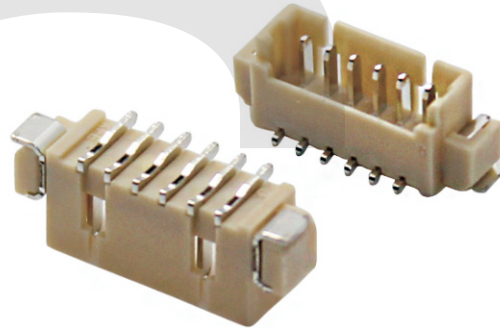

### Vertical SMT

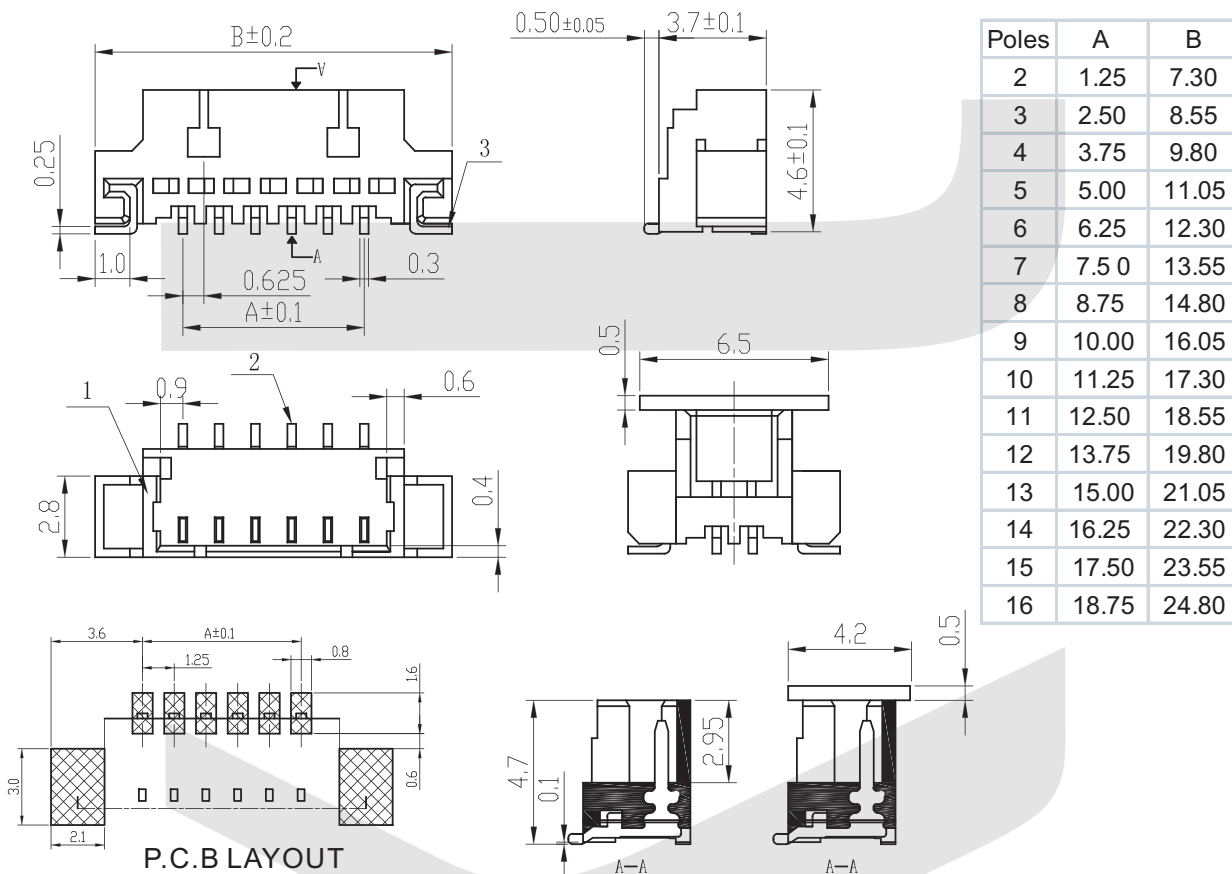

## ORDER INFORMATION

Product NO.: KLS1-XL1-1.25-02-VM

Series No. \_\_\_\_\_ Type: H=Housing T=Terminal  
 Pitch: 1.25=1.25mm S=Straight Male pin R=Right Male pin  
 PIN Number: 2~16pin VM = Vertical SMT RM = Horizontal SMT